

46/30

A PLANNED UNIT DEVELOPMENT Fountains South

30

TRACTS B-7 AND B-8

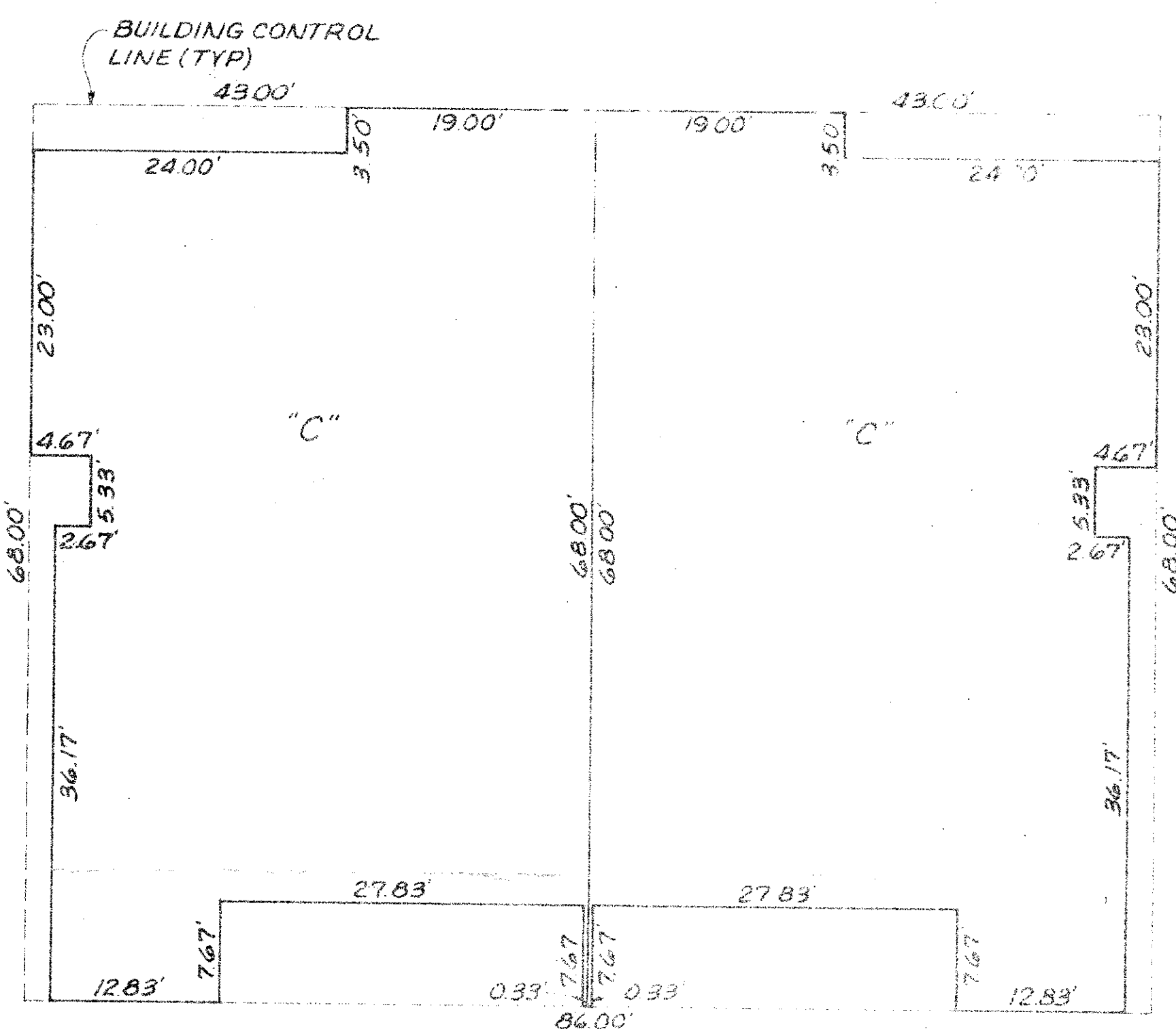

TYPE ①

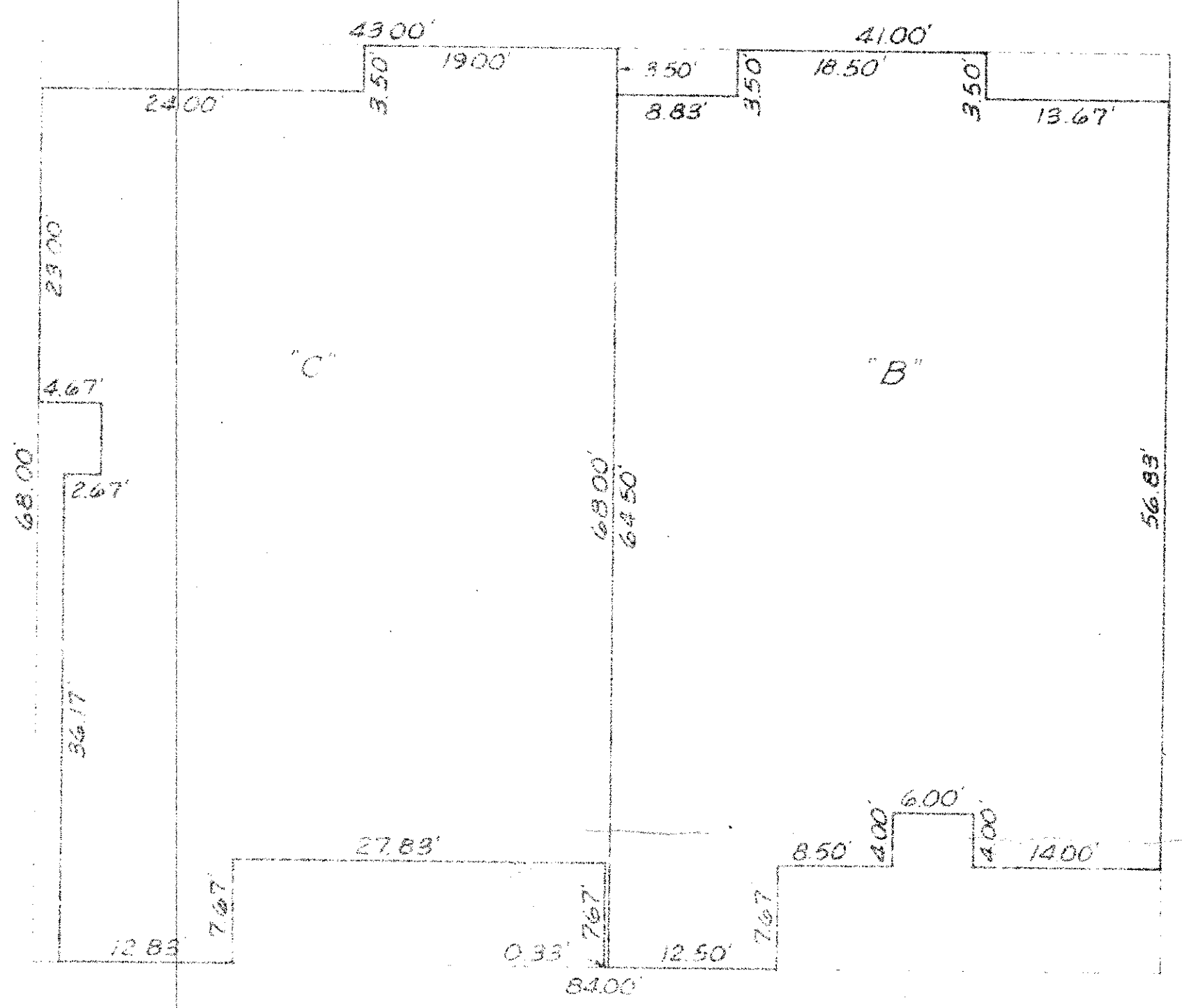

TYPE ②

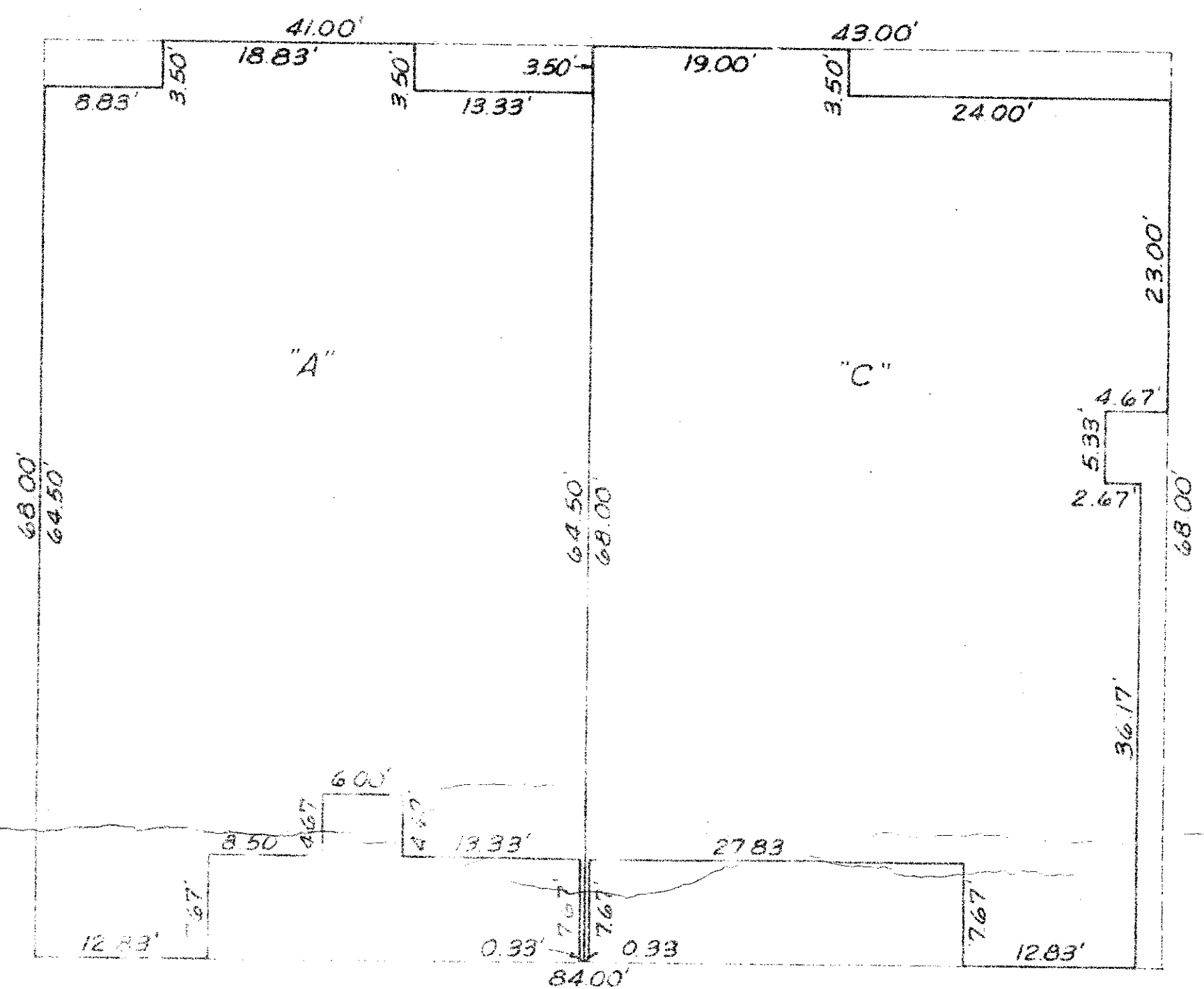

TYPE ③

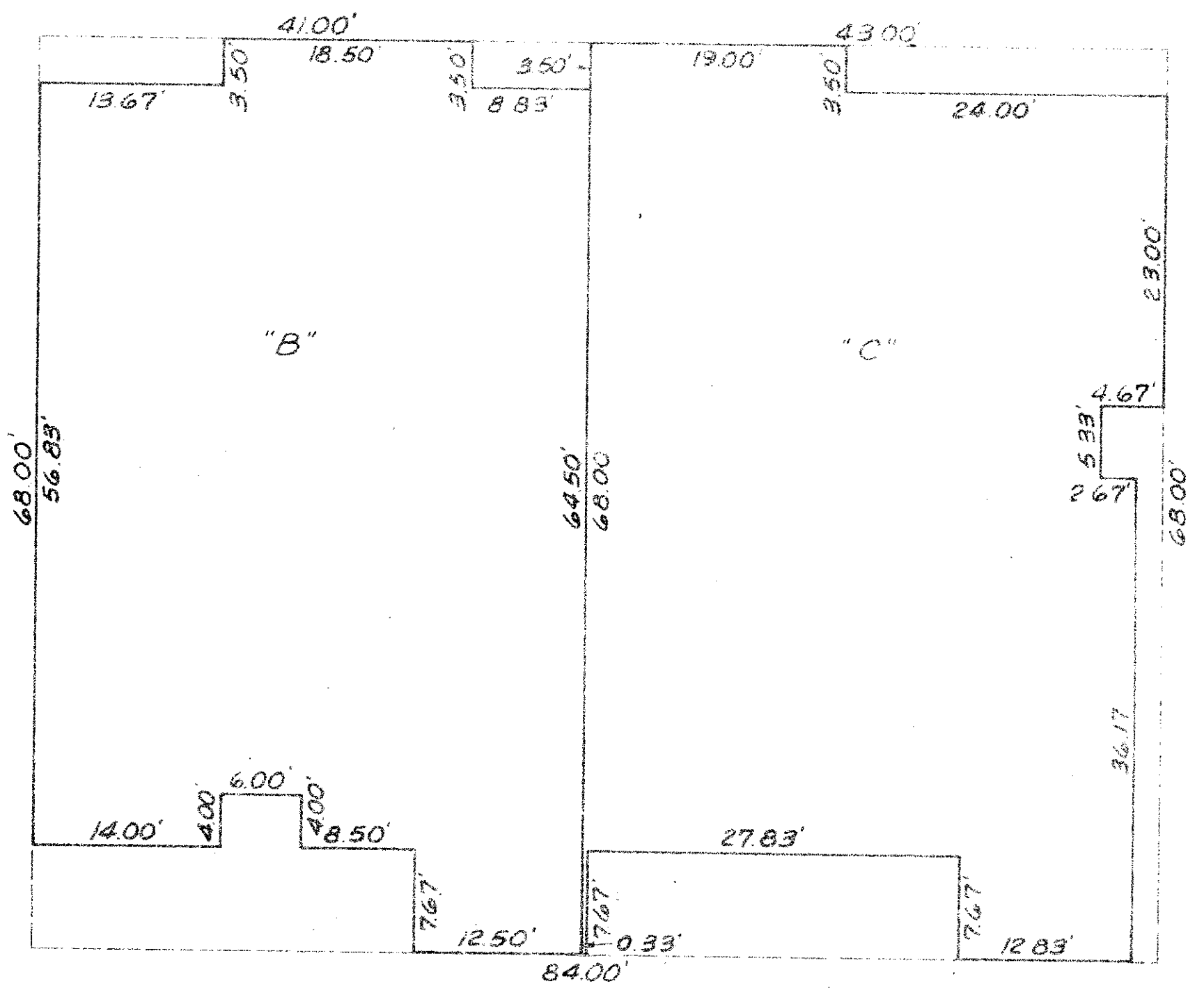

TYPE ④

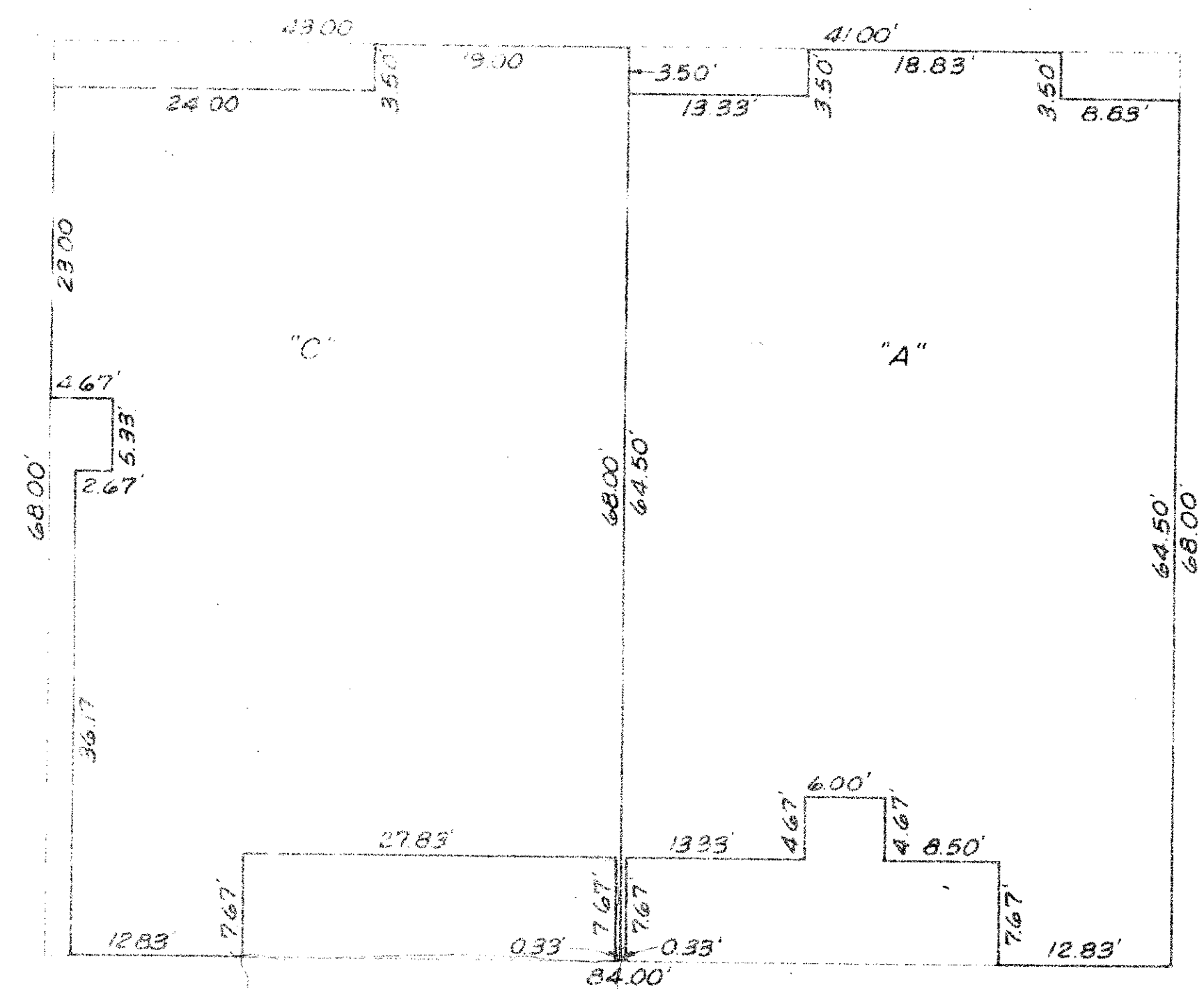

TYPE ⑤

BUILDING UNIT NOTES

- indicates BUILDING CONTROL LINE
- indicates building line
- "C" indicates building unit type obtained from plans provided by Ginocchio and Spina, architects.
- All units are one (1) story, C.B.S. Villas.
- All building lines as shown hereon are at right angles (90°).

46/30 0244-305

ADAIR & BRADY, INC. CONSULTING ENGINEERS & LAND SURVEYORS <small>WEST PALM BEACH</small>			FOUNTAINS SOUTH TRACTS B7 AND B8 RECORD PLAT
Dr. MBL CK. gp Ap. JA	Scale 1"=10' Date JUNE, 1983 Job No. 95620		